

# PRODUCT DATASHEET

## Fila Night SE

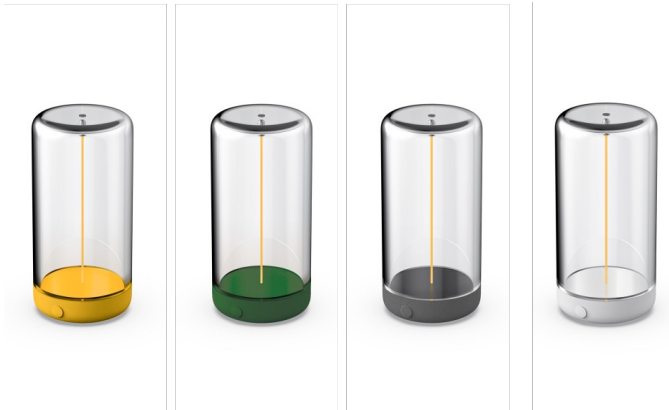

---

### Area of application

- Living areas
- Bars and restaurants
- Office
- Outdoor balcony

---

### Product benefit

- The 1.5mm thin filament boasts flexibility and thermal endurance
- Excellent light quality and 360-degree uniform illumination without shadows
- Playability and interactivity of flexible magnetic filaments

---

### Product feature

- Integrated rechargeable lithium battery which can be charged USB cable



## TECHNICAL DATA

### Electrical data

Nominal wattage	0.9 W
Nominal voltage	5.0 V
Mains frequency	0 Hz
Nominal current	1000 mA
Protection class	III
Operating mode	Battery

### Photometrical data

Luminous flux	55 lm
Luminous efficacy	MAX 60 lm/W
Color temperature	2700 K
Light color (designation)	Soft White
Color rendering index Ra	> 80
Standard deviation of color matching	< 6 sdc <sub>m</sub>
Photobiological safety group acc. to EN62778	RG0
Photobiological safety group acc. to EN62471	RG0

### Dimensions & Weight

Length	70.0 mm(2.7")
Width	70.0 mm(2.7")
Height	145.0 mm(5.7")
Product weight	190.0 g

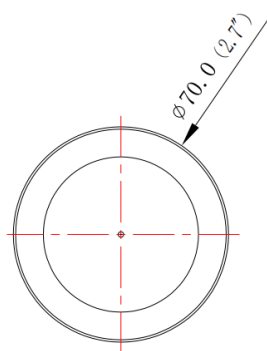

unit:mm/Inch

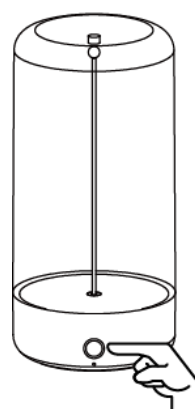
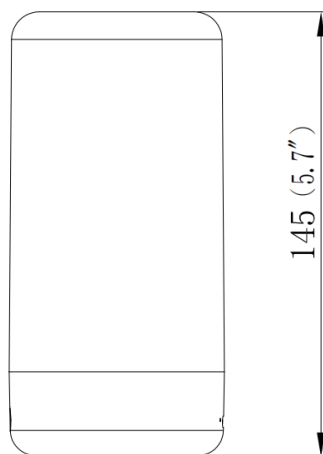

-  **Touch 1 time:** 10% brightness
-  **Touch 2 times:** 100% brightness
-  **Touch 3 times:** Breathing
-  **Touch 4 times:** power off

## Materials & Colors

Product color	Yellow,/Green/ Smoky/ White
Housing color	Clear
Body material	PC ABS

## Application & Mounting

Ambient temperature range	-20 °C...+40 °C
Type of connection	USB
Type of protection	IP54
Function	3-Step Touch Dim, 10%-100%-Breathing
Mounting type	Portable
Application environment	Outdoor
LED module replaceable	Not replaceable
With light source	Yes

## Lifespan

Lifespan L70/B50 at 25 °C	15000 h <sup>1)</sup>
---------------------------	-----------------------

1) t<sub>70</sub>: L70 / B50 @ 25 °C (Ta), t<sub>80</sub>: L80 / B10 @ 25 °C (Ta), t<sub>90</sub>: L90 / B10 @ 25 °C (Ta)

## BATTERY

Type of Battery	Lithium ion
Battery size [GMS]	18500 18mm*18mm*51mm
Number of included batteries	1
Nominal voltage of battery	3.7V
Nominal capacity of battery	1500mAh
Battery Charging time	2H
Usage time after fully charged	13H@max brightness

## Certificates & Standards

Standards	CE/FCC/RohS/REACH
Battery	UN38.3

---

## EQUIPMENT / ACCESSORIES

- 0.5m usb-type c charging cable include

---

## LOGISTICAL DATA

Packaging unit (Pieces/Unit)	Dimensions (length x width x height)	Gross weight	Volume (CBM)
Color box(1pcs/1box)	104 mm x 95 mm x 185 mm(4.1"x3.7"x7.3")	280 g	0.0018 m <sup>3</sup>
Shipping box(50pcs/1box)	545 mm x 497 mm x 396 mm(21.5"x19.6"x15.6")	11093 g	0.11 m <sup>3</sup>

---

---

## DISCLAIMER

Subject to change without notice. Errors and omission excepted. Always make sure to use the most recent release.